



Company Contact: Mandi Butler

Contact Info: 541-744-2660

email: [webinfo@futurebhomes.com](mailto:webinfo@futurebhomes.com)

Value Today ... Years to Come  
Since 1980

## WALLACE

## CRESCENT VILLAGE

### Starting at \$349,000

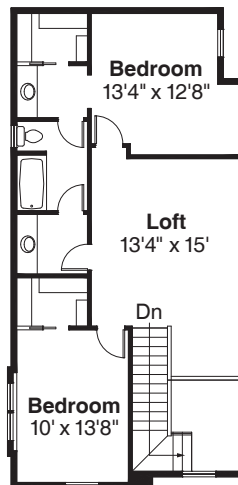
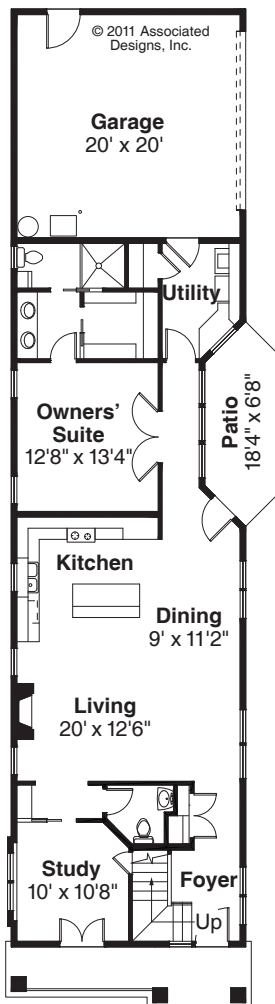

- 2,069 sq. ft. of Quality Living Space
- 3 bedrooms, 2.5 baths
- Opportunity to select finishes & colors
- Master Suite on the main level
- Study/Guest with private entrance
- Abundant hardwood floors
- **Heat N' Glo** gas fireplace
- Custom built **Lanz** cabinets
- **Kohler** plumbing fixtures
- Kitchen with quartz slab counters
- Stainless steel appliance package
- 2-car garage with attic storage
- "Dark Charcoal" 40-year comp. roof
- Covered front porch & patio
- Stucco exteriors (some with wood paneling accents)
- **Marvin All Ultrex** windows in "Ebony"
- Ornamental iron fencing
- Landscaped and sprinkled
- BUILDER'S HOME WARRANTY
- Available on Lots 42, 45, & 54
- **ENERGY STAR/EARTH ADVANTAGE Certified Home**



CCB# 36499

FUTURE B HOMES: P.O. Box 7425, Eugene, Oregon 97401

[www.futurebhomes.com](http://www.futurebhomes.com)

Estimated price subject to final verification. Illustrations are designer's concept only. Drawings may not be to scale and some changes may have been made by the Builder with the goal of improving design and function.